



LOCATIONS

MISSISSAUGA ON 731 Gana Court, L5S 1P2
(905) 564-5404

THUNDER BAY ON 1-888-456-6567
(807) 577-5724

SUBURBY ON 1-800-465-5044
(705) 222-1042

WINNIPEG MB 112 Fielding Rd Unit C, P3Y 1L5
(204) 632-8269

BRANDON MB 2525 Inkster Blvd, R2R 2Y4
(204) 632-8044

REGINA SK 1440 Highland Ave, R7C 1A7
(306) 757-5606

SASKATOON SK 1523 Ross Ave E, S4N 7E5
(306) 242-3465

LOYDMINSTER AB 3445 Miners Ave, S7K 7K9
(780) 875-9115

CALGARY AB 5701 63rd Ave, PO Box 11530, T9V 3B8
(403) 236-9712

RED DEER AB 170 Queens Dr, T4P 0R5
(403) 343-1383

EDMONTON AB 16230-118th Ave, T5V 1C6
(780) 447-4422

GRANDE PRAIRIE AB 10610 82 Ave, Claimont AB, T0H 0W0
(780) 402-9864

PARTS ✚ SERVICE ✚ EQUIPMENT ✚

www.fgild.com



If you receive duplicates of this flyer or if your address requires changing, please fax the label to the Point of Mailing. Indicate the mistake and we will update our records.

Point of Mailing:
2525 Inkster Blvd
Winnipeg, MB R2R 2Y4
Fax (204) 956-1786

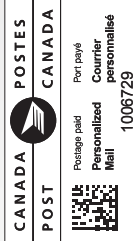

Postage paid
Personalized
Courier
Mail
1006729

PRIVACY COMMITMENT - FGI is committed to protecting your privacy. We collect, use and disclose personal information only in accordance with the FGI Privacy Code and FGI's Commitment to Privacy statement. If you have questions regarding our policies or procedures, wish to review your information, or change or withdraw your consent to the use of your information, access the FGI Privacy Code and Commitment to Privacy at www.fgild.com or contact FGI's privacy officer by email at privacy@fgild.ca, by phone at 1-800-282-8044, or by mail at FGI's Head Office in Winnipeg.

All sales subject to PST and/or GST/HST and Enviro Fees where applicable. Prices subject to correction and may change without notice. Products may not appear exactly as illustrated.

Offers expire July 31st, 2017

Reward yourself at
www.fgild.com/tbf



FGI

MODEL 234

Heated 4" Round LED Tail Lights - Model 234

NEW



- FMVSS/SAE/DOT APPROVED
- USES ONLY 8 WATTS TO EFFECTIVELY MELT ICE AND SNOW
- INCLUDES PIGTAIL

0346261 \$62⁹⁵ ea

J.W. SPEAKER
Engineered. Lighting. Solutions.

www.fgild.com

Rotella T6 5W-40



Full Synthetic Extreme Temperature Heavy Duty Engine Oil (Replaces 550023679)



550045390 - 5L **\$39⁹⁵ea**



Single Axle Fenders

- 16 gauge stainless steel fender
- 3 Rib Construction
- 80" L x 24" W



NF180SS1 **\$205⁰⁰ea**



Fender Center Mounting Bracket

Universal - 8-1/2" x 11-5/8"

N230PMLH - Left Hand **\$49⁹⁵ea**
 N230PMRH - Right Hand **\$49⁹⁵ea**

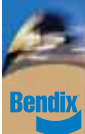

QR-L In-Line Quick Release Valve

Rapidly exhausts supply or control air pressure from vehicle air lines. Uniquely suitable as an air system performance enhancement due to its 0 psi crack and differential pressure. Direct Mount.



800333 **\$26⁹⁵ea**

QuickBinder Plus Ratchet LoadBinders

- Safe, convenient folding handle doesn't obstruct or get in the way
- 3-point pawl offers ratchet extension
- Use with G-70/80 Chain



H5125-0658 - 5/16-3/8", 7,100lb WLL **\$49⁹⁵ea**
 H5125-0858 - 3/8-1/2", 12,000lb WLL **\$59⁹⁵ea**



30875 - 2 x 147ml Kit **\$36⁹⁵kit**
 30874 - 1 x 147ml Cartridge **\$19⁹⁵ea**

Set-Right™ Heavy-Duty Hub Rebuild Kits



Where You Turn

Rebuild Your Hubs & Get the Timken Advantage

- Meets or exceeds OEM specs
- OE spacer kit included to simplify wheel-end rebuilds
- Reduce wheel end repair inventory
- Available for steer, drive, and trailer wheel ends
- Engineered exclusively for pre-adjusted wheel hubs



FFTC1 - SET427/428 **\$122⁰⁰ea**
 RDTC1 - SET429/430 **\$175⁰⁰ea**
 TNTC1 - SET431/427 **\$165⁰⁰ea**



4" Backup Lights

- Hermetically sealed to prevent water intrusion
- Requires two lamps to meet backup function
- Fits standard 4" lamp grommets and brackets

62171 - Incandescent / Polycarbonate lens **\$5⁹⁵ea**
 62691 - LED / ABS lens **\$29⁹⁵ea**



BriteZone™ Mini Square LED Work Lights

- Compact 2.81" x 3.86" suits various applications
- PC lens, aluminum housing, & swivel SS bracket
- Voltage Amp: 9 - 32 Volts, 8.1W, 775 Raw Lumens



BZ6015 **\$39⁹⁵ea**



Receive E-Flyers via Email:

We will send a PDF of our sales flyers and product bulletins in their entirety to any interested. Please note that we are very protective of our subscriber information. We never sell, trade or Please send an email to subscribe@fgilttd.ca if you would like to be added to our contact list.

Axle Fasteners

ZIP-TORQ



- Simplified & Fully Unitized Design
- Prevents Back Off
- Compatible with most automated installation equipment

- 4004723 - "P" Parallel Trailer 22,500#, SET415 Brgs **\$55⁹⁵ea**
 4004743 - "N" Tapered Trailer 17-22,500#, SET413 Brgs **\$45⁹⁵ea**
 4004973 - "R" Drive 34-46,000#, 50,000#, SET401 Brgs **\$54⁹⁵ea**

LINCOLN

Variable Speed Pneumatic Grease Gun



- Fully automatic continuous operation.
- Accessible check valve assembly.
- Comfortable grip
- 30" high-pressure hose w/coupler and attachment clip
- Incl. combination filler nipple and bleeder valve

LIN1162 **\$109⁹⁵ea**

P.T.O./Pump Control Valve

- Controlled Lowering (Feathering)
- Automatic Disengagement of the P.T.O. in "Lower"

- K90 - Standard Valve **\$180⁰⁰ea**
 K90C 8" Console for K80/K90 **\$32⁹⁵ea**
 K90TC 14" Console for K80/K90 **\$36⁹⁵ea**



MOBILE

INNERSPACE

Luxury Truck Mattresses

- 6.5" thickness
- Firm Support comfort core provides rejuvenating sleep
- Double-sided quilted breathable cover
- 15-year limited warranty

- TK3579 35 X 79
 TK3880 38 X 80
 TK4280 42 X 80 From **\$239⁹⁵ea**



DESIGNED FOR THE PROFESSIONAL DRIVER

MILTON INDUSTRIES, INC. Truck Tire Gauges

Accurate and reliable. USA made!

- S920 - Pencil type; 10-70 PSI w/Depth Gauge **\$8⁹⁵ea**
 S928 - Pencil type; 5-50 PSI, For Fluid Filled Tractor tires **\$9⁹⁵ea**
 S929 - Truck type; 120 PSI, Brass, STR Foot Dual Head **\$11⁹⁵ea**
 S932 - Dial type; 0-60 PSI Single Chuck **\$25⁹⁵ea**



5LB Dry Chemical Fire Extinguisher

- 3A-40B-C Rating
- Steel Cylinder w/durable powder coat finish
- Strong Polyester powder coat steel handles
- Comes w/vehicle bracket and 6 yr warranty
- 17-1/8L x 4-3/8" dia



ABC-050VWDL **\$49⁹⁵ea**

SPIN-ON COOLANT

w/o chemicals

BALDWIN
FILTERS



- For Long Life Extended Services Coolants
- 5-7/16" x 3-11/16" dia

BW21000 - Donaldson DBC486; Fleetguard WF213 **\$53⁹⁵ea**

FUEL/WATER SEPARATOR SPIN-ON

- Filter w/open port for bowl
- 3-1/2 in H. x 4-3/8 in dia.
- Fits Freightliner Trucks; Racor Fuel Systems



BF460160 - FRHT ABPN122R50551 **\$32⁹⁵ea**



LED Headlight Conversion Kits

- 4000 Lumens per bulb (2 per kit)
- Cool White 6500K
- CREE-XHP-50 chip
- Compatible with all makes/models



Hi-Low Beam Models H4, H13, 9004, 9007 **\$229⁹⁵ set**
 Single Beam Models H1,H3,H11, 9005, 9006, 9012.....



- ✓ Removes guesswork out of load height measurement
- ✓ Spring loaded hinge design
- ✓ Fast, easy, and accurate up to 15'
- ✓ Collapses to only 5'

51824 **\$179⁰⁰ ea**

Fifth Wheel Repair Kits

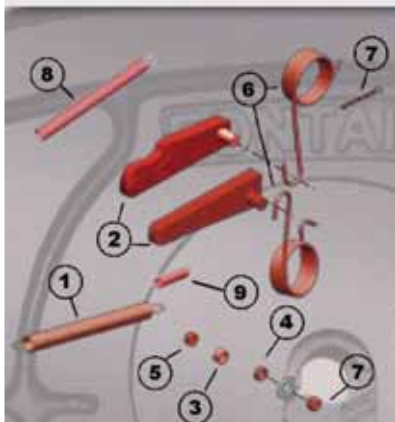

- 1 - Bumper Spring
- 2 - Step Jaw & Wedge Spring Set (L.H. Release)
- 3 - Bushing, 7/16"
- 4 - Bushing, 5/16"
- 5 - 3 x Hex Lock Nut, 1/2" - 13
- 6 - Jaw & Wedge Spring Set (KITRPR5092 Only)
- 7 - Cotter Pin, 1/4" x 3" (KITRPR5092 Only)
- 8 - Handle Spring (KITRPR6000 only)
- 9 - Timer Spring (KITRPR6000 only)

5092 Series
 KITRPR5092L **\$399⁰⁰ ea**

6000 Series
 KITRPR6000L **\$396⁰⁰ ea**

Haldex FLIPPER VALVE

Panel mount Hand Operated Style Valve
 Made of durable Engineering Grade Composite
 An on-off, non-automatic two position valve
 All ports 1/8"
 Mounting holes are #10-24 on 1.5" centers



KN20001 **\$35⁹⁵ ea**



PERMALITE™ XB High Output LED Dome Light

- Passive infrared (PIR) motion sensor w/shut off time
- 100° Movement detection at 16.4 ft max
- 20 LEDs/2200 lumen output
- Current AMP draw: 1.5A at 12V
- Operating temperatures: -40°C to 80°C



5122221 **\$199⁰⁰ ea**

PHILIPS Aux Dual Pole Plugs

- Heavy duty reinforced zinc die-cast housings
- Provides separate power and ground connections
- 4ga. plug offers 100 amp continuous capacity
- 6ga. plug offers 70 amp continuous capacity



15338 - 4 ga. **\$19⁹⁵ ea**
 15339 - 6 ga. **\$19⁹⁵ ea**

PHILIPS STA-DRY® S7™ Nose Box

- Includes 20 amp circuit breakers
- Swivels 40° each way to follow the tractor
- Automatic disconnect feature eliminates damage to components
- Over 50% more interior room



169520 **\$173⁰⁰ ea**

FGI SUMMER WORK GLOVES

- Split cow hide leather
- Cotton drill back
- Shirred elastic wrist
- Slip-on style safety cuff



104FGI **\$5⁴⁹ ea**